



Scape

Herbert Strutt Primary School, Derbyshire

Derbyshire County Council commissioned Scape technology for a new building to replace the existing Herbert Strutt school. The new 1360m² single storey building was constructed on a new site and was designed to sit well within the landscape.

The school is a 'Flagship' for sustainable building with on site energy generation and energy conservation features such as high insulation levels and rainwater recycling.



The Scape frame provides a predominately column free interior which allows for future changes to the internal wall arrangements. The external wall uses prefabricated insulated panels provided by Kingspan and Kawneer windows. The wall finishes are acrylic render and rainscreen panelling.

Curved Frame

The building is the first to use the newly developed Scape 'curved module' which gives the plan its distinctive 'S' shape. The curved steel frame has external wall panels and the windows faceted. The external wall finish however follows a true curve.



Case Study

Flexible Teaching Spaces

The school has 6 classrooms and 1 nursery room for approximately 200 pupils aged 4-11. The arrangement of classrooms follows the model established at the Mundy School, with a flexible wall located in the additional 'corridor' position.

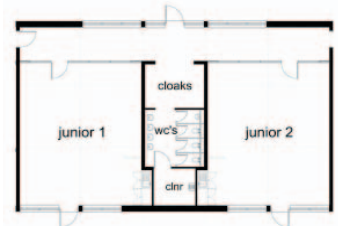

Natural Cross Ventilation

The natural ventilation strategy relies on low level and clerestory window openings to take advantage of cross and stack ventilation. The heating, supplied by ground source pipework, is underfloor throughout which frees up the wall elevations. The building is set on a slope which has been extensively landscaped with play areas, ecological resource areas and trees.

